

PLAN COFRAJ CAMIN TIP 6

SECTIUNEA 1-1

SCARA 1:50

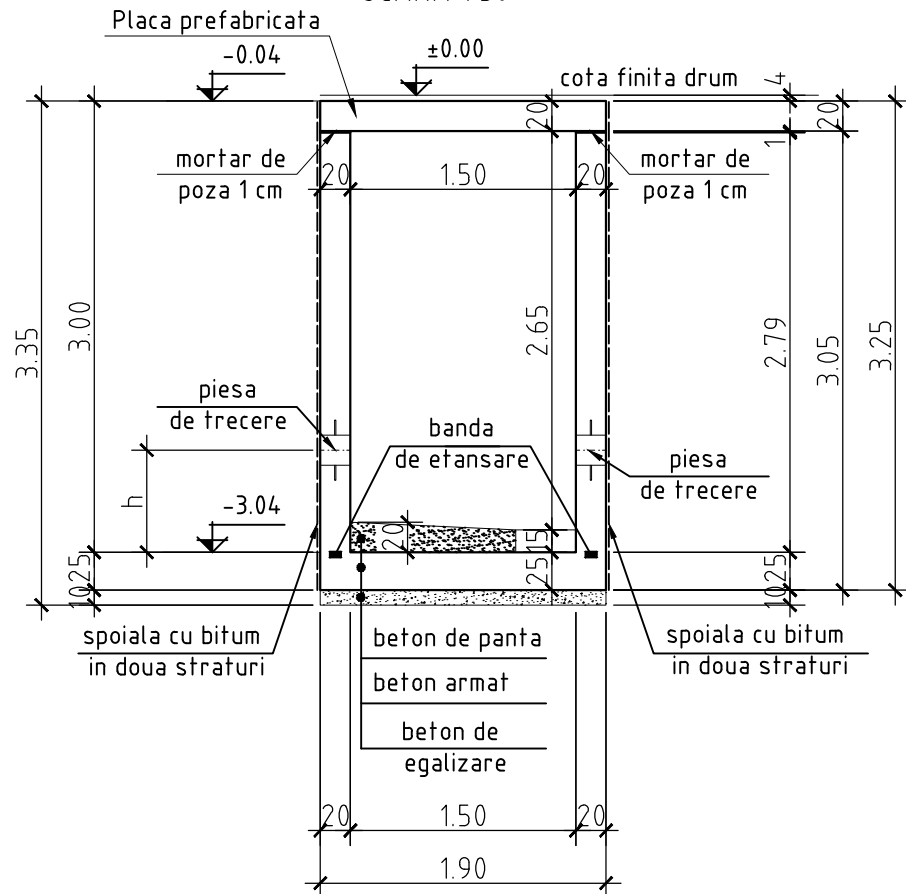

PLAN COFRAJ
PLACA PREFABRICATA

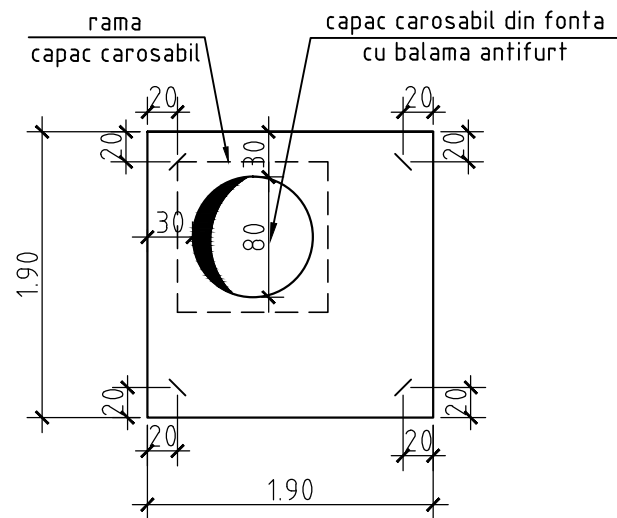

SECTIUNEA 2-2

SCARA 1:50

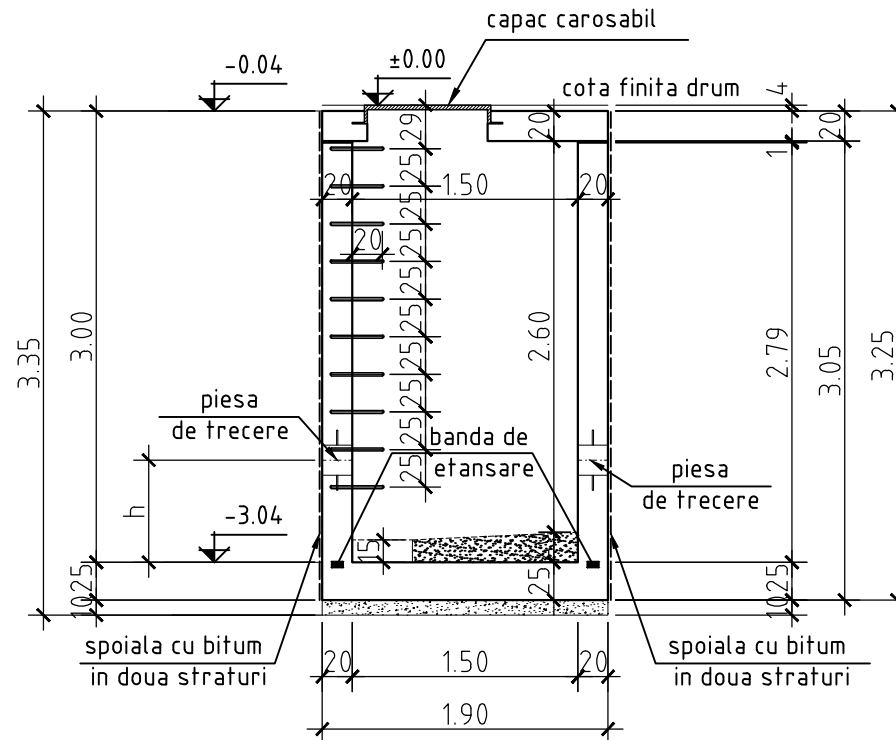

SECTIUNE ORIZONTALA

SCARA 1:50

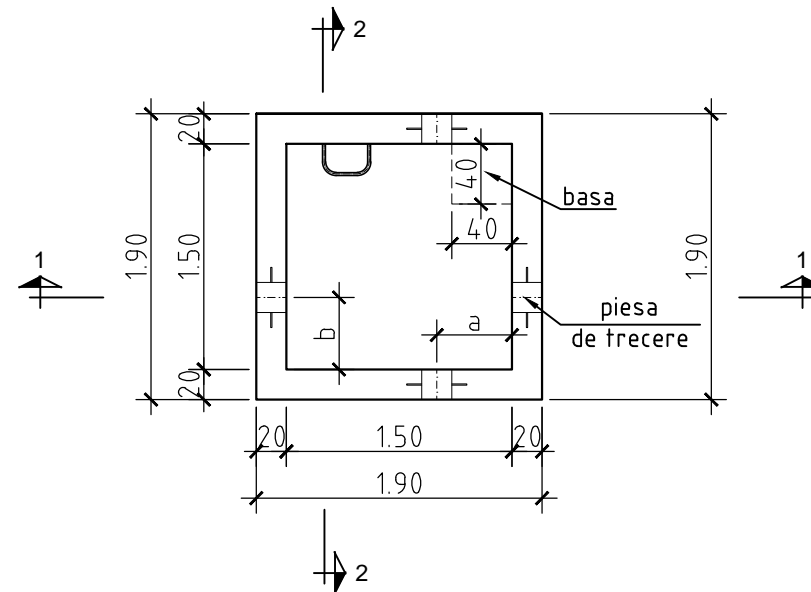

Rev	Num	Ver	Aprb	Data	Descriere

Autoritatea contractanta: **S.C.AQUACARAS S.A. CARAS SEVERIN**



Adresa: P-ta Republicii, nr. 7, Resita
Jud. Caras Severin
Tel.: +40 255 212 458
Fax.: +40 255 214 421
E-mail:office@aquacaras.ro

Proiectant: **Consorțiu S.C Eptisa Romania
S.R.L. si Eptisa Servicios de Ingeniería S.L.**
Șos. Dudești-Pantelimon nr. 42, RAMS center, et. 5, corp A,
sector 3, București
Tel.: + 40 21 301 14 70
Fax: + 40 21 301 14 80
www.eptisa.com

The logo for Eptisa, featuring the word "eptisa" in a stylized, lowercase font. The "e" and "p" are blue, while the "t" is orange and has a unique shape with a dot. The "i" and "s" are blue, and the "a" is also blue.

Project:
MODERNIZAREA INFRASTRUCTURII DE
APA SI APA UZATA IN JUDETUL
CARAS SEVERIN - AGLOMERAREA RESITA

Plansa:

Retele apa
Camin tip 6-Plan Cofraj

Desenat:	Ing. B. Paraschiv	Data: Feb. 2013
----------	-------------------	-----------------

Verificat:	Ing. M. Serbanoiu	Data: Feb. 2013
------------	-------------------	-----------------

Aprobat: Ing. D. Spiridon  Data: Feb. 2013

Plansa nr.	Revizia
------------	---------

CS-RE-PT/DA-A-R-6.1

0